

VersaLoupe™

10x LED Lighted Focusing Loupe

Congratulations on selecting your new VersaLoupe™! In order to achieve optimum performance, please follow instructions for proper use and care.

PRODUCT SPECIFICATIONS

Weight:	0.1 lbs
Dimensions:	2.3" x 2.3" x 1.7"
Battery:	(1) CR2032



ACTIVATING LED LIGHT

Remove battery tab and slide switch to turn LED on/off.

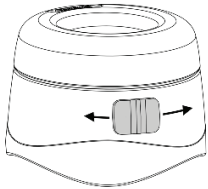

FOCUSING LOUPE

Place loupe over viewing subject. Turn focusing ring until image is sharp.

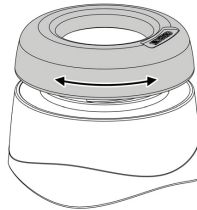

REPLACING BATTERY

1. Turn loupe over and locate the battery cover inside acrylic base.
2. Unscrew cover and remove as shown below.
3. Install new CR2032 coin cell battery with the correct polarity as indicated on battery cover.
4. Reattach battery cover and secure with screw.

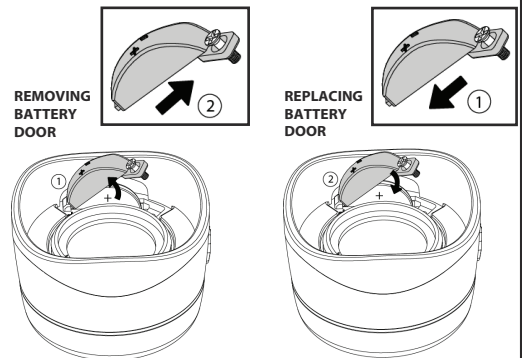

Note: Battery may be difficult to remove by hand. Needle nose pliers are recommended.

WARNING

- This product uses lithium coin cell batteries, which are NOT rechargeable. We do not recommend rechargeable batteries (lithium ion) for this product. Keep away from fire or excessive heat. Inspect battery for corrosion or leakage. Insert in direction indicated. Discard button cell battery carefully. Keep button cell batteries away from children.
- Keep magnifier away from direct sunlight to prevent accidental fires.
- Viewing the sun can cause permanent eye damage. Do not view the sun with this item.
- Do not place LED lights directly on your eye as this may cause damage as well.

CLEANING

Clean lens with a soft, clean microfiber cloth by rubbing gently in a circular motion. Moisten the lens cloth with water if necessary. Do not use harsh chemicals, solvents or abrasives as they may damage the lens.

Customer Service:

If you experience any difficulties, please contact us and we will be happy to help you.



✉ info@carson.com



✉ uksupport@carson.com



✉ eusupport@carson.com

For warranty information, visit www.carson.com/warranty

www.carson.com

Carson Optical 2070 5th Avenue, Ronkonkoma, NY 11779 | Tel: 631-963-5000